

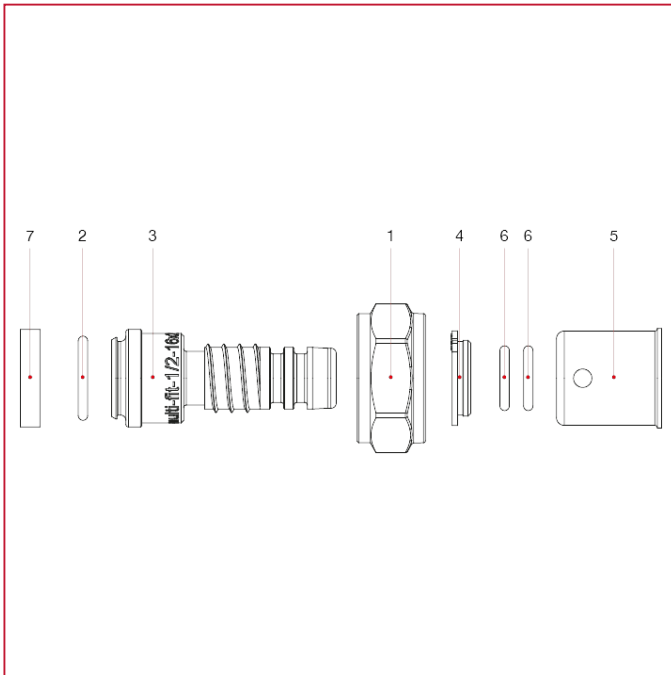

# FITTINGS FOR MULTILAYER, PEX, POLYBUTYLENE AND COPPER PIPE

## 510 Multi-Fit® fitting for multilayer, PEX and polybutylene pipe

### MATERIALS



POS.	DESCRIPTION	N.	MATERIAL
1	Nut	1	Nickel-plated brass CW617N
2	O-ring	1	EPDM
3	Union	1	Brass PTL CW617N
4	Ring	1	Nylon
5	Outside liner	1	Stainless steel AISI 304
6	O-ring	1	EPDM
7	Washer	1	NBR